



# Millbrook

## HEIGHTS



### Presale Models

LOT	MODEL	BED / BATH / GARAGE	SQ FT	SPECIAL FEATURES	PRICE
11	Rockport	4 bed • 2.5 bath • 3 car	2615	Great Room Layout with Bonus and Study	\$349,950
16	Brookside	4 bed • 2.5 bath • 3 car	3055	Formal Living Room with Bonus and Study	\$399,950

Norris Homes reserves the right to make changes to specifications and features without notice. All marketing materials are examples, and not deemed a warranty of any kind. Square footages are approximate. Prices and availability subject to change without notice. Specifications may vary amongst home collections and communities. Last Update 3/1/2010.

#### Norris Homes Feature Highlights include:

Gourmet kitchen with granite slab counters, stainless steel appliances, custom cabinetry, extensive millwork, hand stained hardwood floors, rounded corners throughout, recessed can lighting in many rooms, and 30 year architectural composition roofing.

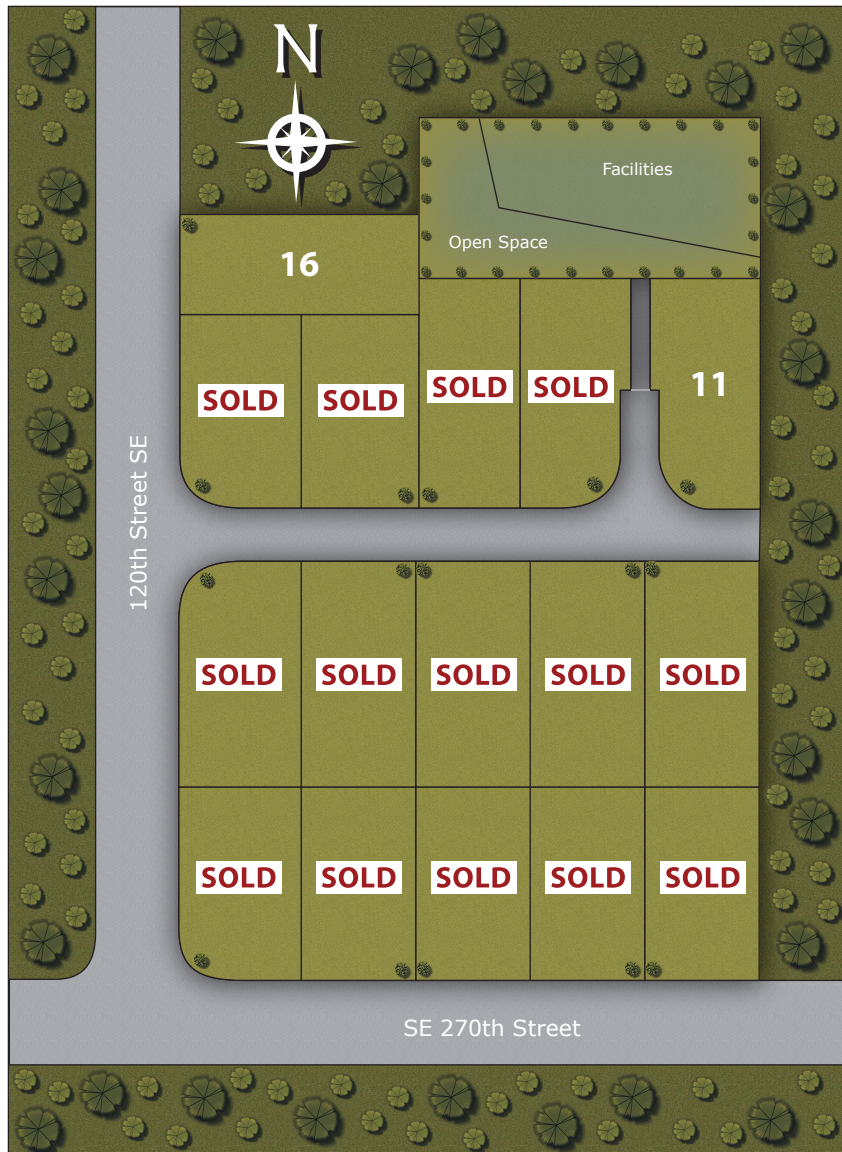

### Corinne Lombardo

(253) 661-5264

[cnorrishomes@windermere.com](mailto:cnorrishomes@windermere.com)

#### Community Features:

- Close to Sounder Train
- Easy access to hwy 18 and hwy 167
- Home from the Norris Classic collection
- Kent school district
- Norris Classic Collection
- Nearby shopping and activities

#### Site Hours:

Call to schedule a private showing with Corinne Lombardo.

#### Driving Directions To:

SE 270th St. and 120th Ave SE, Kent, WA 98042

Southbound Hwy. 167 take the 84th Ave S. Exit (Central Ave N). Turn left on 84th Ave S which becomes Central Ave N. Turn left on E Smith St (516) which becomes Canyon Dr. Just past 104th Ave SE (Benson) veer left onto SE Kent Kangley Rd. Turn right on 116th Ave SE. Turn left on Se 270th St. Turn left on 120th Ave SE.



[www.NorrisHomesInc.com](http://www.NorrisHomesInc.com)